

# BALERNA

## RIQUALIFICA E NUOVA ILLUMINAZIONE DEL CENTRO PAESE

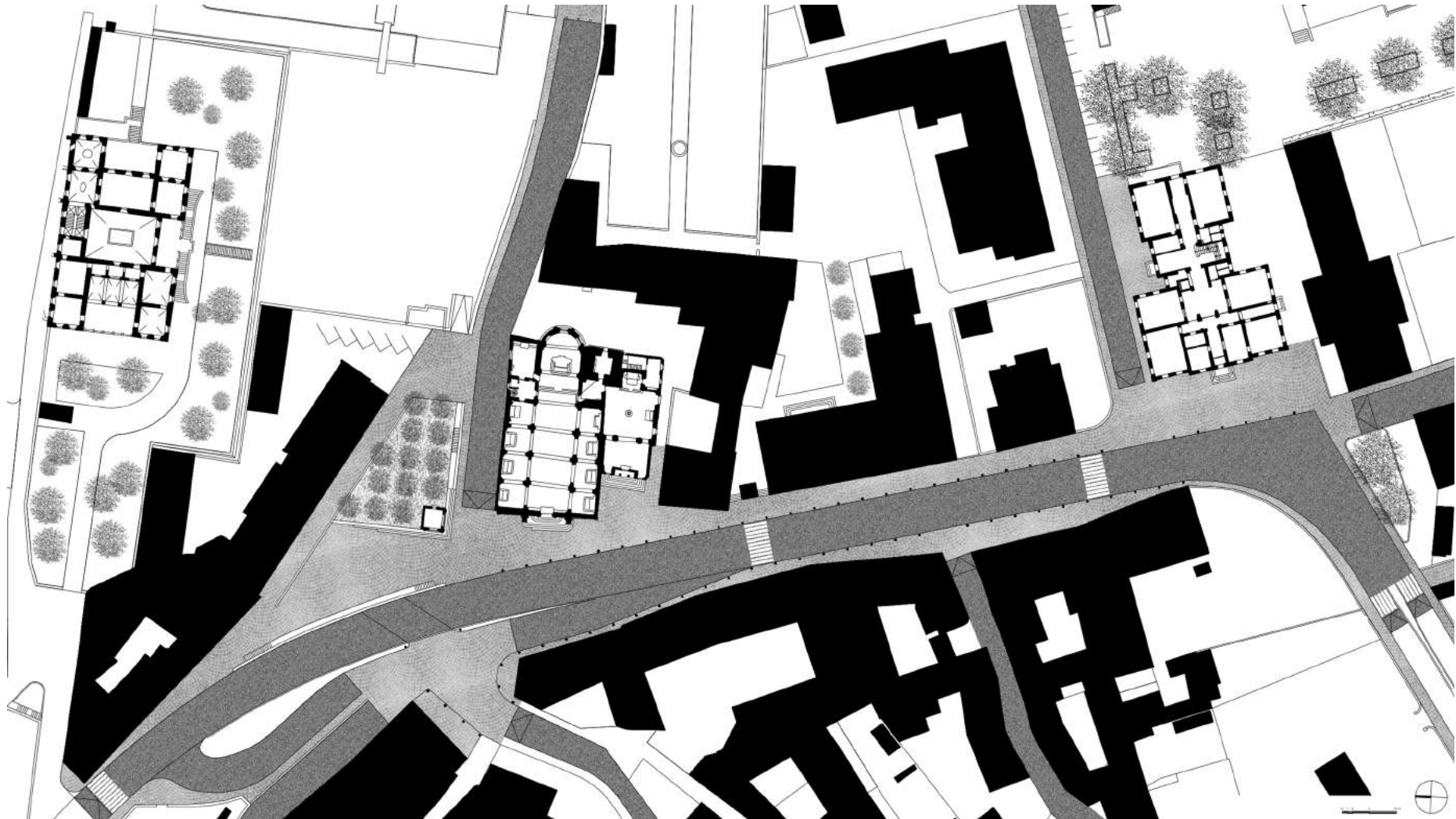

progetto spontaneo – 2008-2009



progetto definitivo – 2011-2017

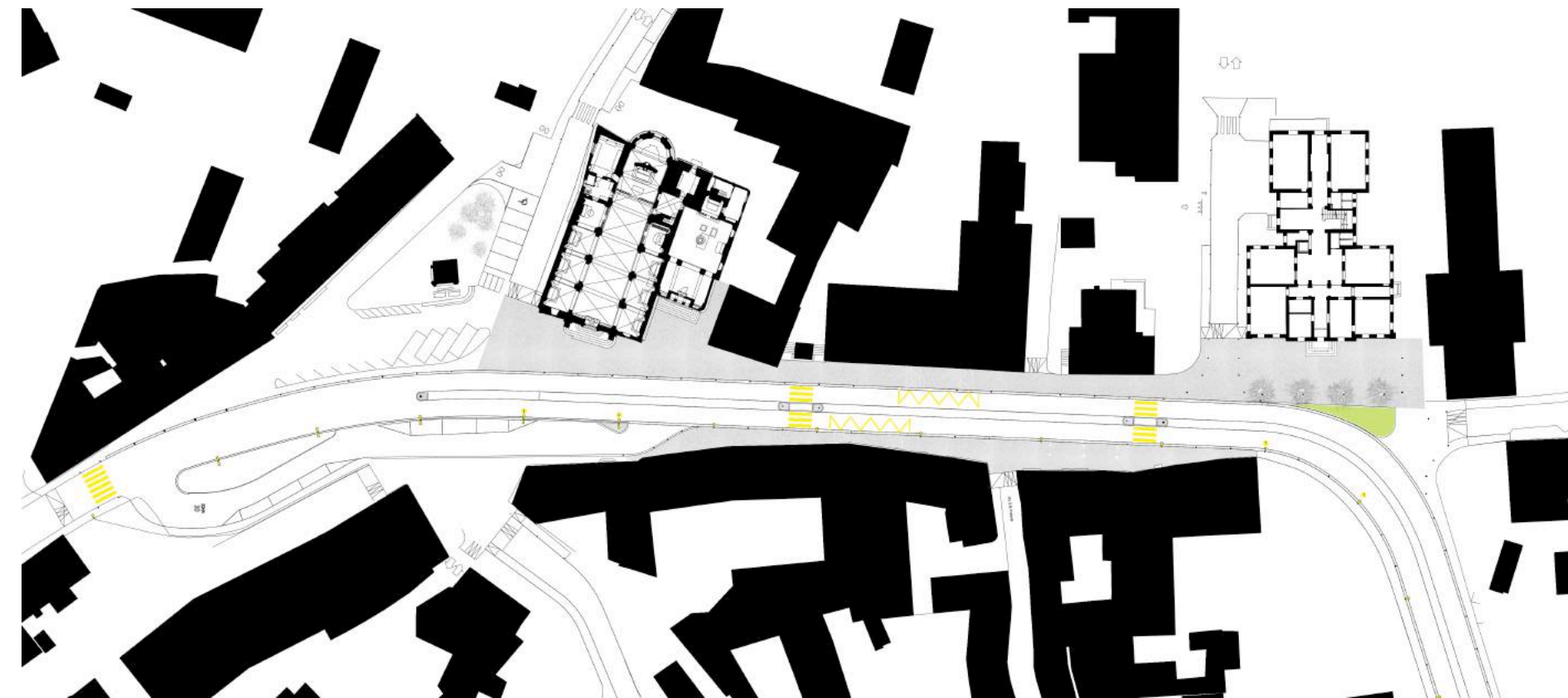

## obiettivi del progetto

- **pedoni** – definizione di percorsi ed attraversamenti, sicurezza
- **traffico** – definizione di una chiara gerarchia dei flussi
- **spazi pubblici** - riqualifica del sagrato della chiesa e di piazza municipio
- **posteggi** – redistribuzione dei posti auto
- **materiali** – scelte ponderate per il contenimento dei costi
- **illuminazione** – facciate di chiesa e municipio, decorazioni natalizie







**Studio di  
ingegneria Fabio  
Bianchi**

Ingegneria civile, edile e del  
traffico

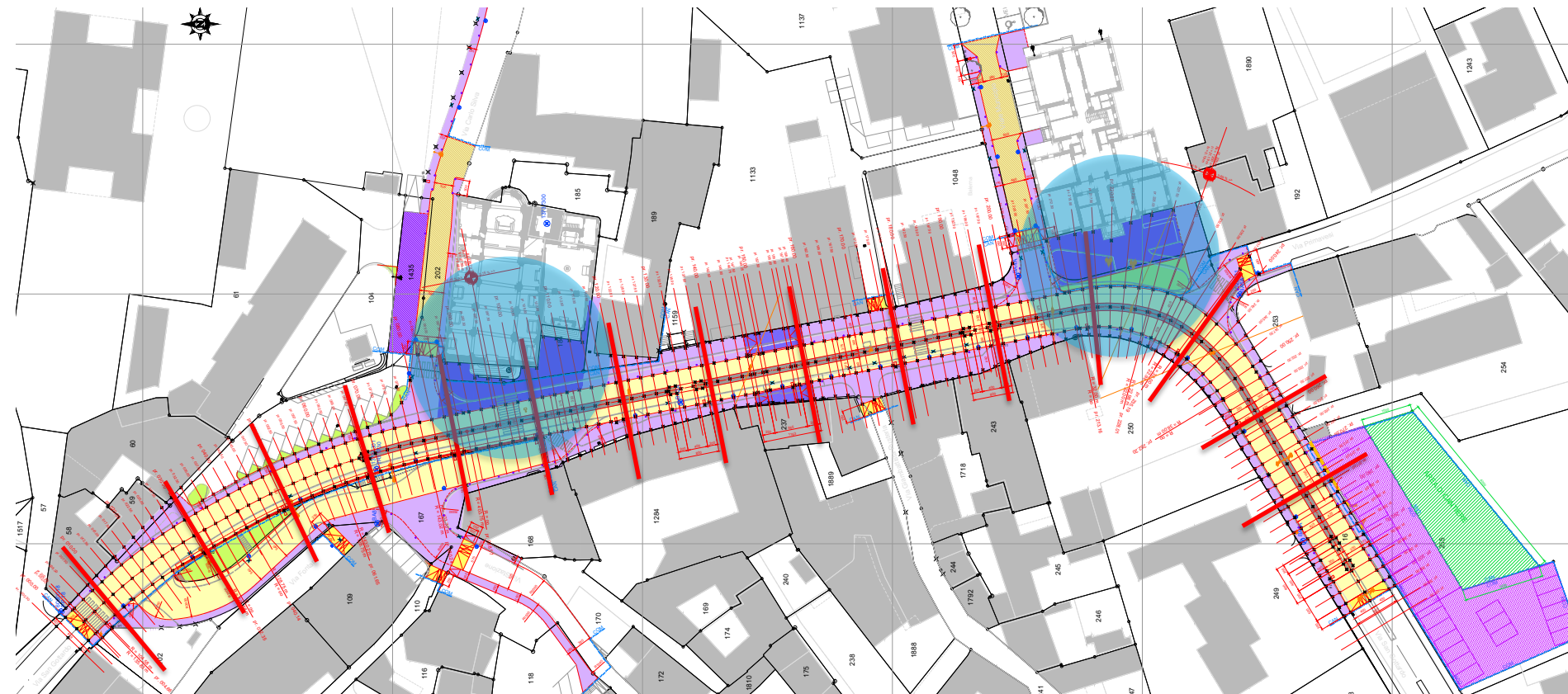



**Studio di ingegneria Fabio Bianchi**  
 Ingegneria civile, edile e del traffico

**siteco**  
 AN OSRAM BUSINESS



- Streetlight 10 mini LED**
- For residential roads, collecting roads and plazas
  - For outdoor and logistics areas in industry
  - Mounting heights: 4 to 8m
  - Max spacing: up to 40m
  - Light color: 3,000K, 4,000K, 5,000K
  - Variante from 2,300 lumens to a power variant with 6,100 lumens

- Streetlight 10 micro LED**
- For residential roads, side streets and pedestrian paths
  - Mounting heights: 3 to 8m
  - Max spacing: up to 40m
  - Light color: 3,000K, 4,000K, 5,000K
  - Variante from 950 lumens to a power variant with 2,354 lumens

**SEZIONE TIPO "C"**  
 pr. 140.00 - 1:50

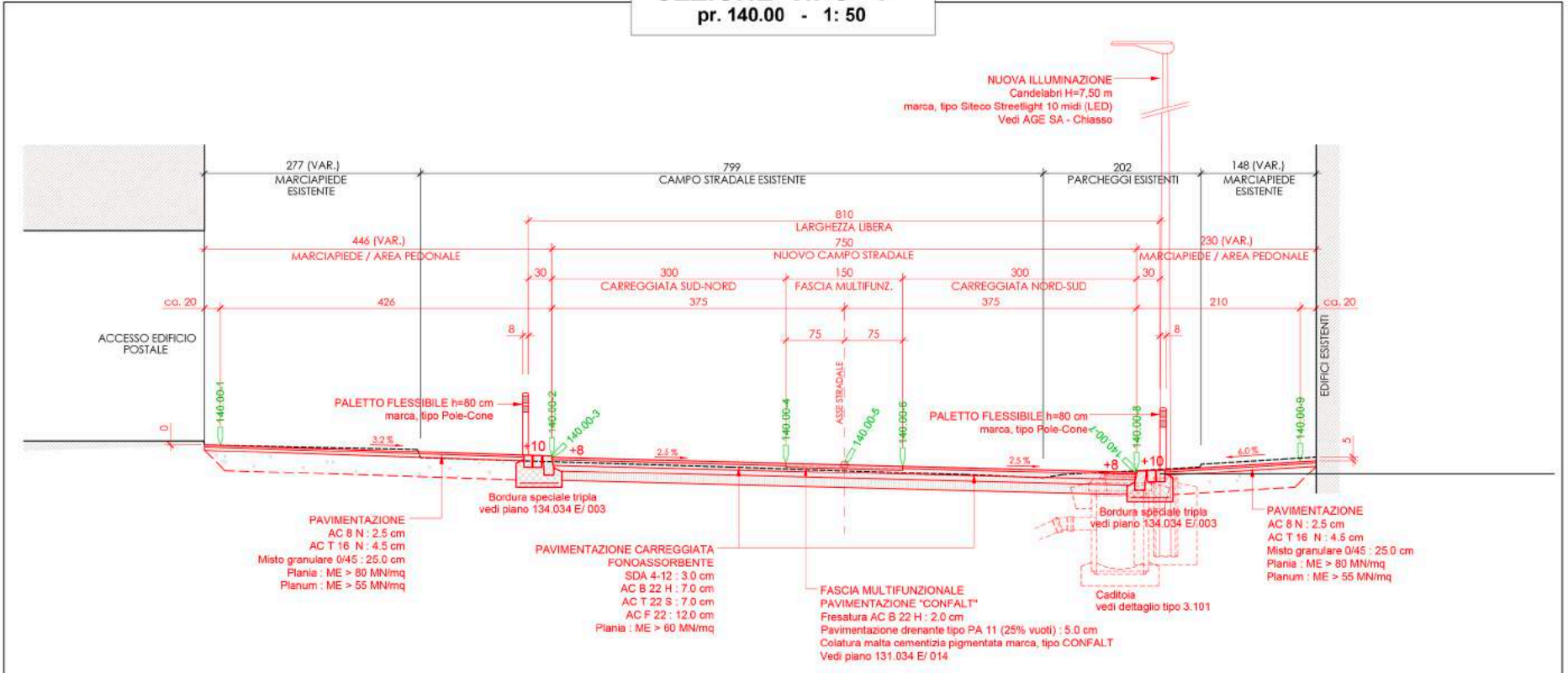

# progetto illuminazione – facciate di chiesa e municipio



# progetto illuminazione - chiesa

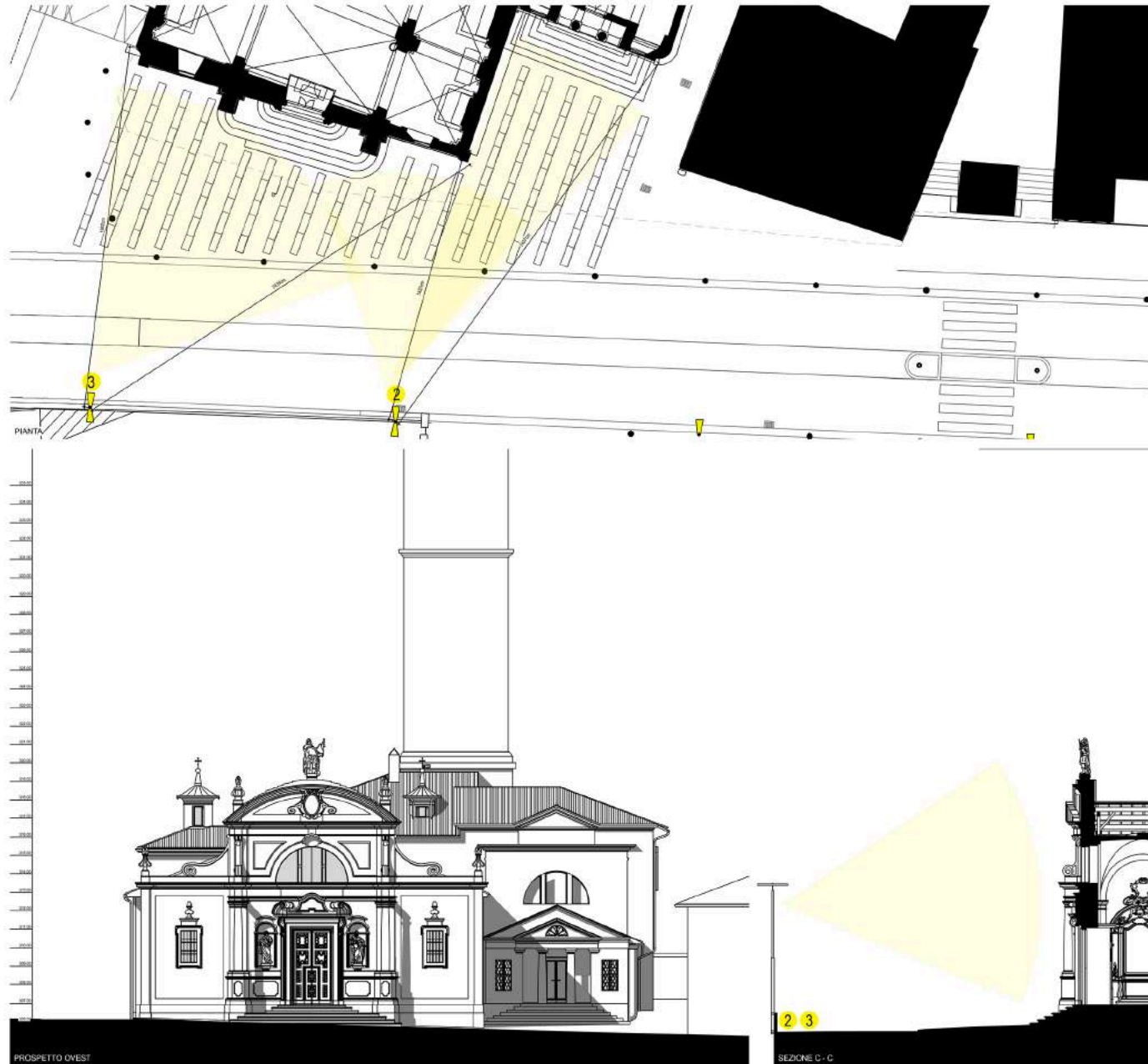



# progetto illuminazione - municipio

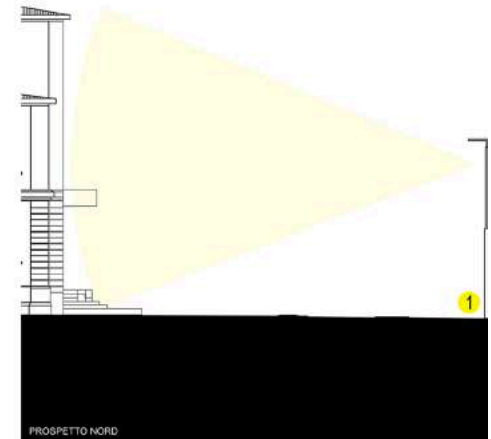
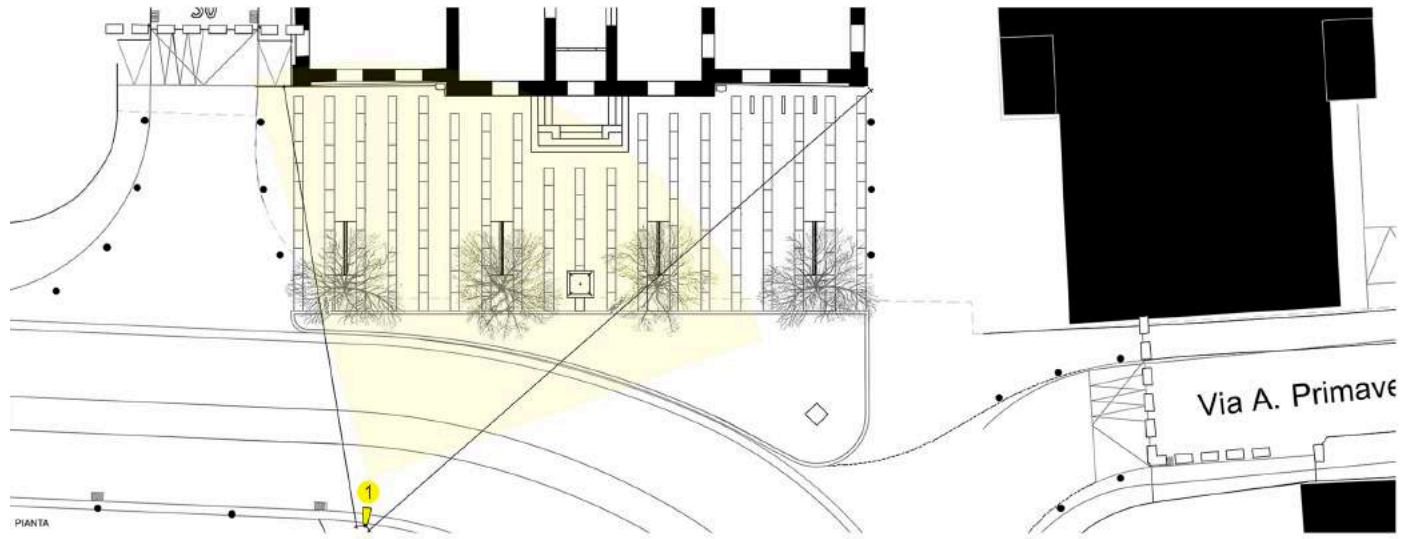

# progetto illuminazione – piano ditta specializzata - opticalight®

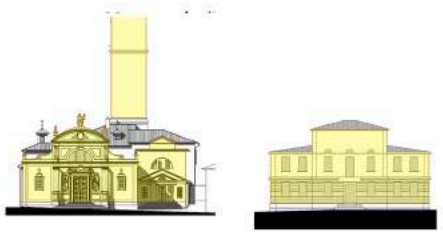
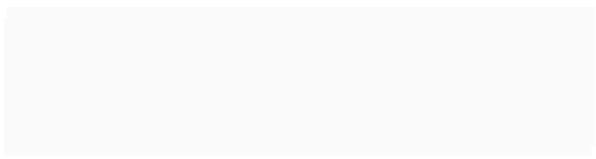
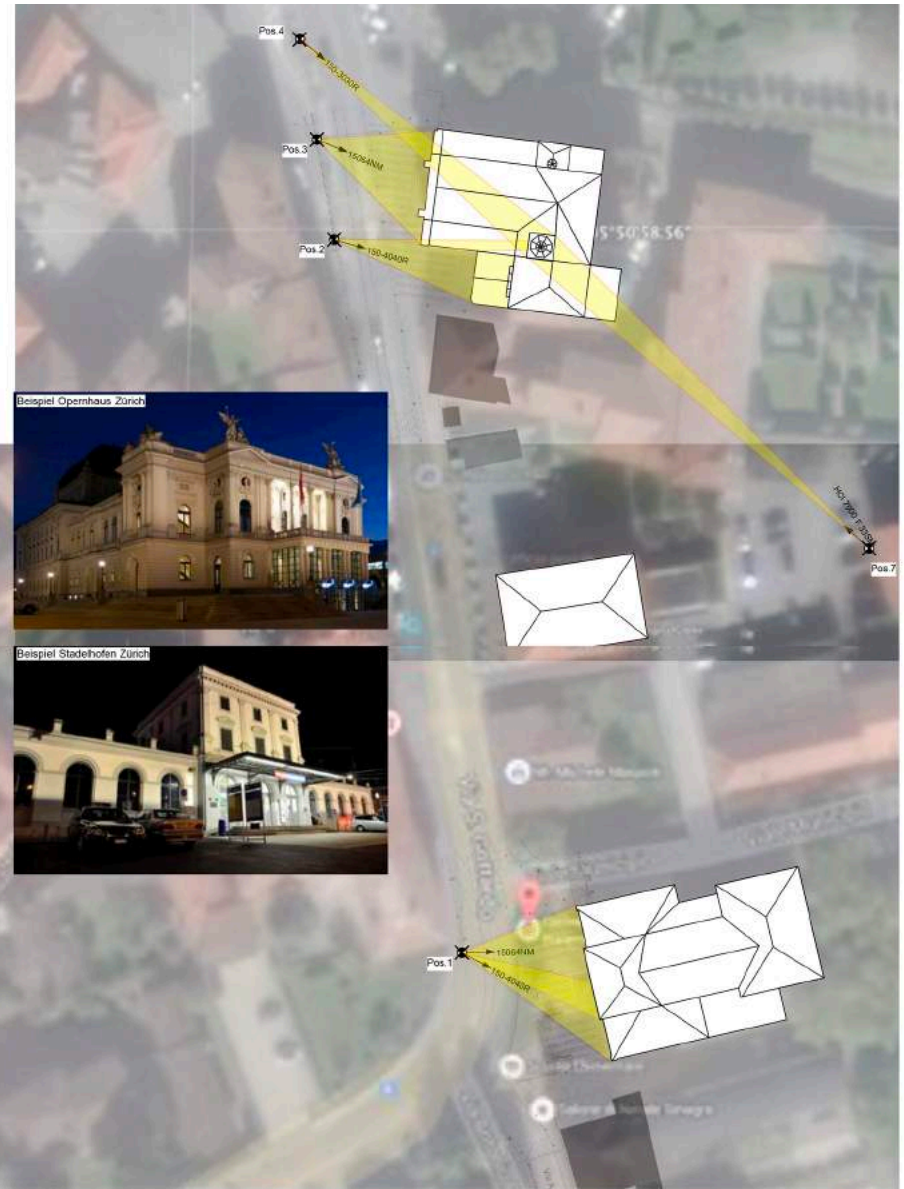

Position	Fixtures	KW
1		
2	1	0.165
3	1	0.165
4	1	0.165
5		
6		

Position	Fixtures	KW
7	1	0.165
8		
9		
10		
11		
12		

Position	Fixtures	KW
13		
14		
15		
16		
17		
Total	4	0.66

# progetto illuminazione – piano ditta specializzata - opticalight®

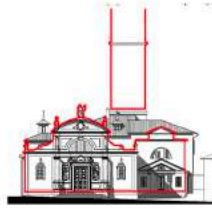
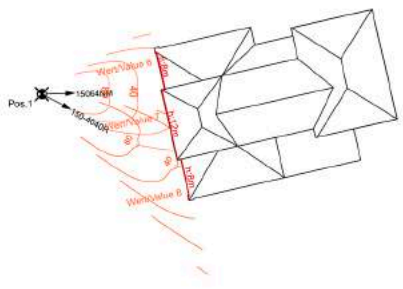
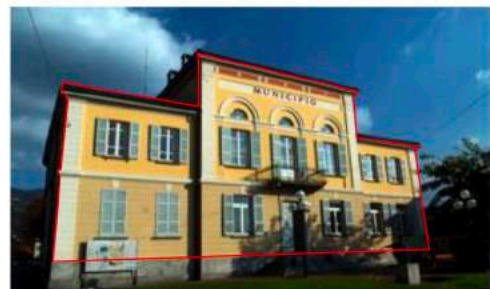
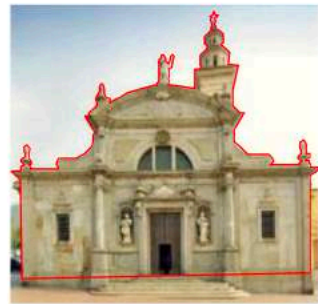
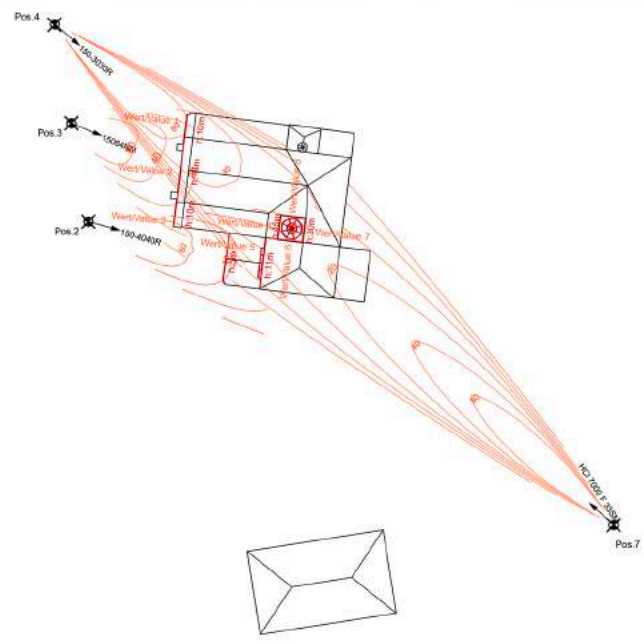

Wert / Value	Lux (E)	Lux (Eh)
1	16	15.8
2	25	25.0
3	14	11.2
4	24.4	20.0
5	27.5	27.5
6	23.7	23.6

Wert / Value	Lux (E)	Lux (Eh)
7	23.6	21.9
8	29	26.1
9		
10		
11		
12		

Wert / Value	Lux (E)	Lux (Eh)
13		
14		
15		
16		
17		
18		

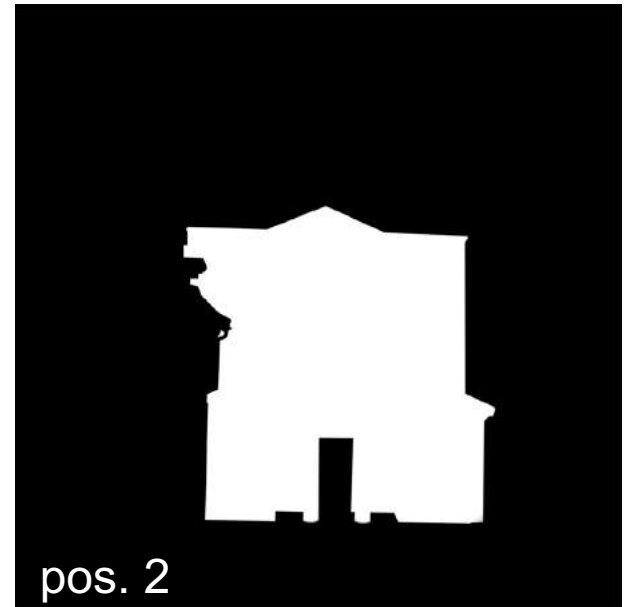
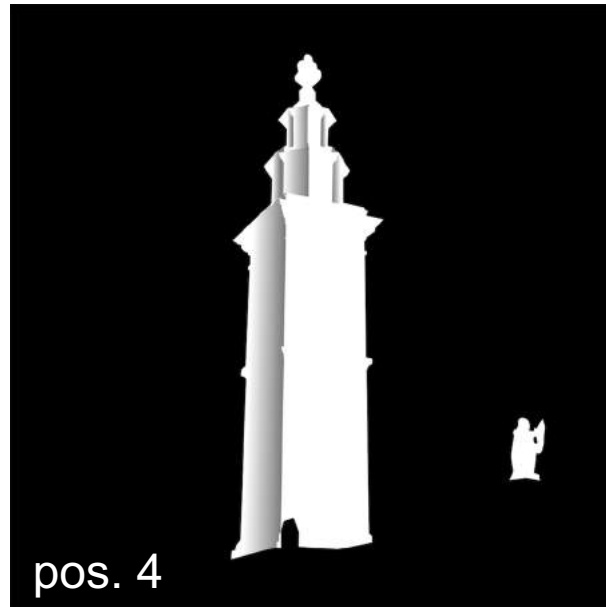
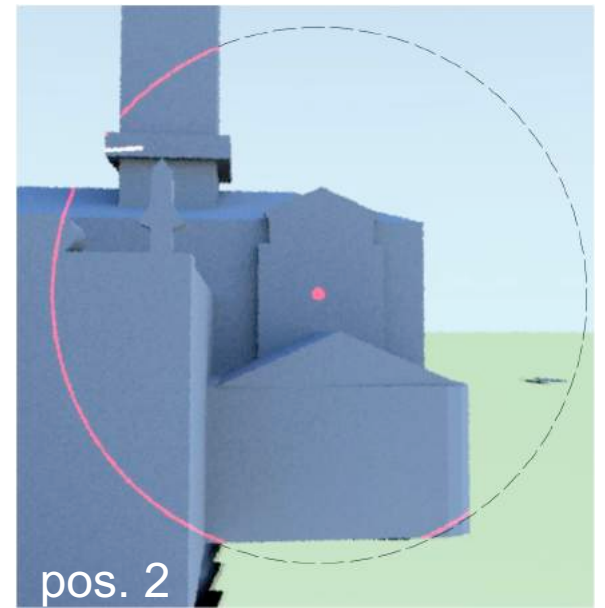
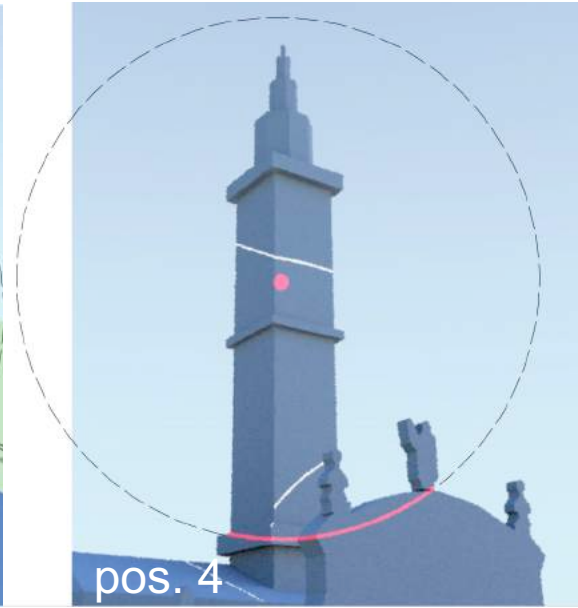
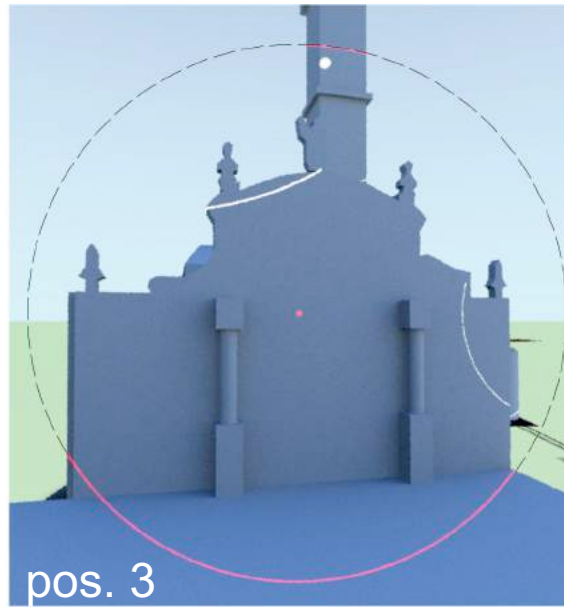



progetto illuminazione – maschere - opticalight®

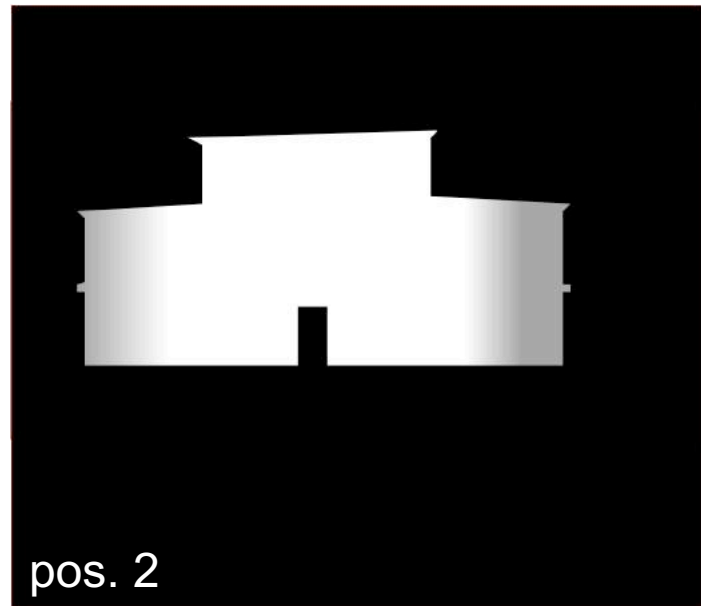
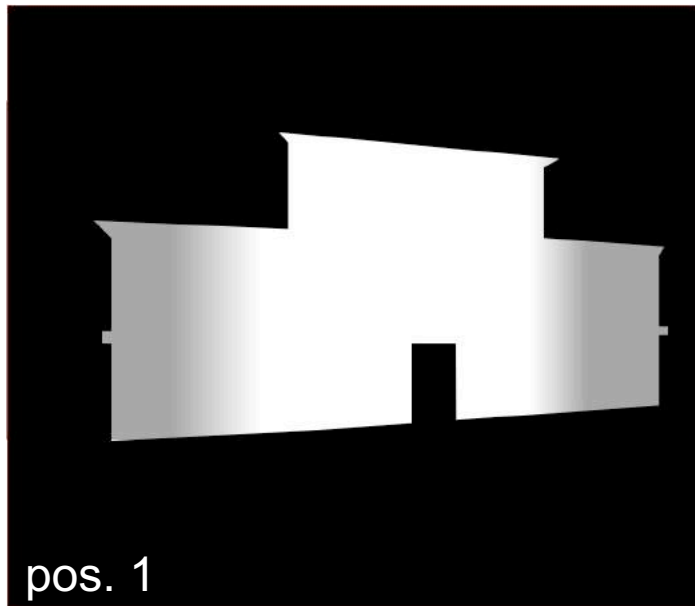
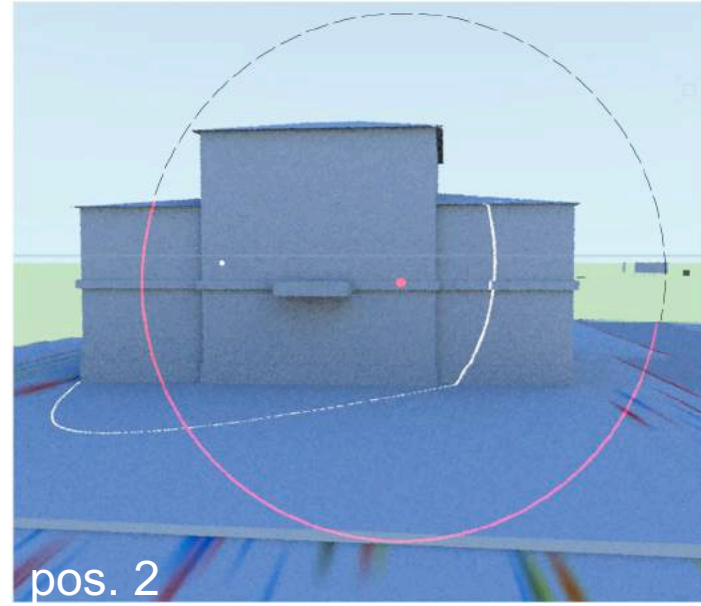
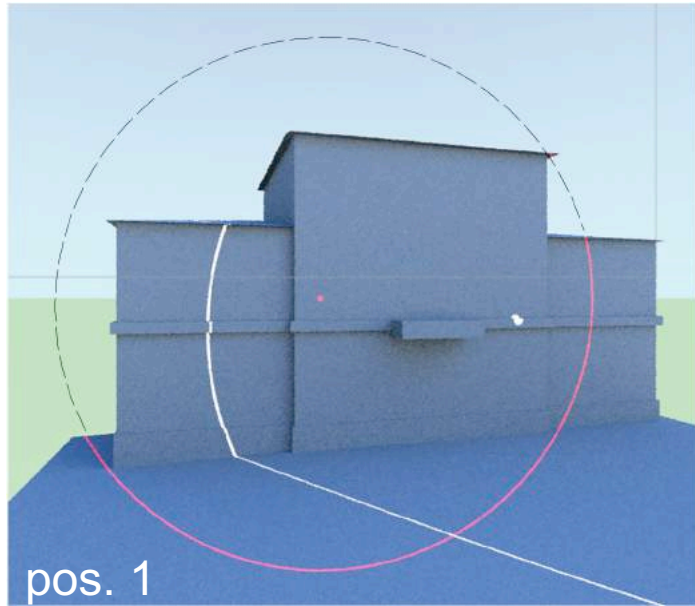

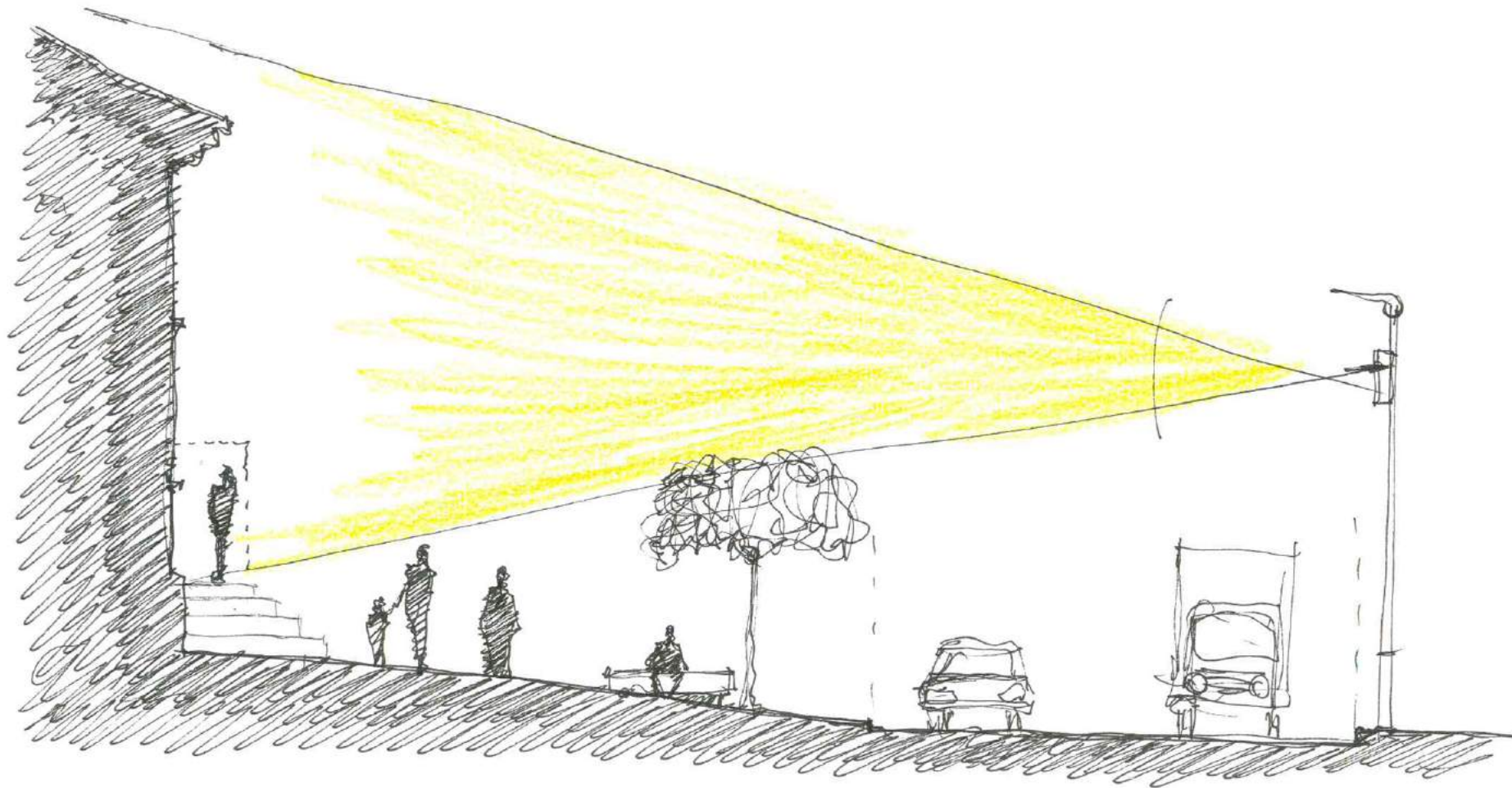





# progetto illuminazione – maschere e filtri - opticalight®

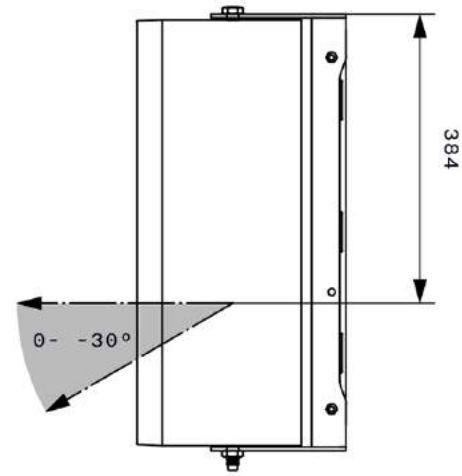
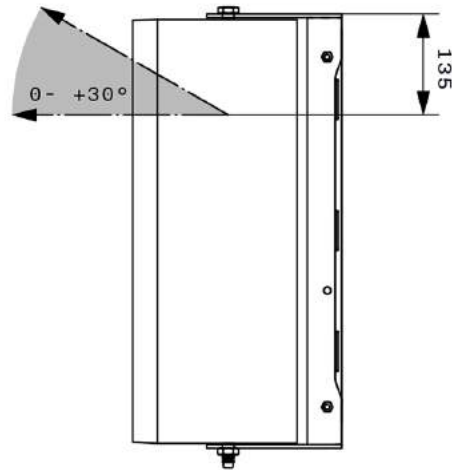
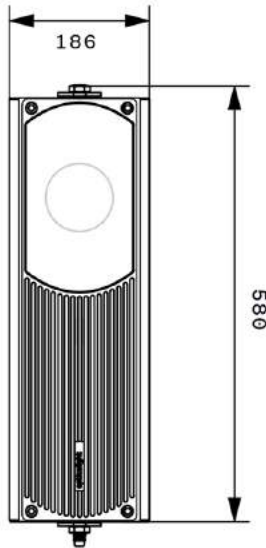
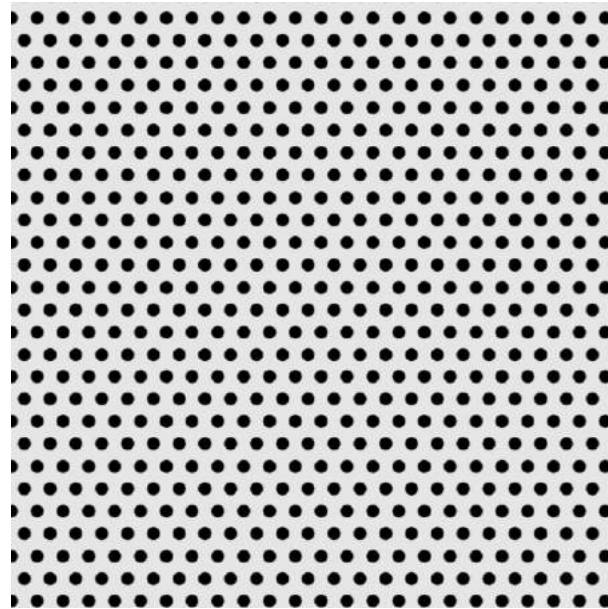
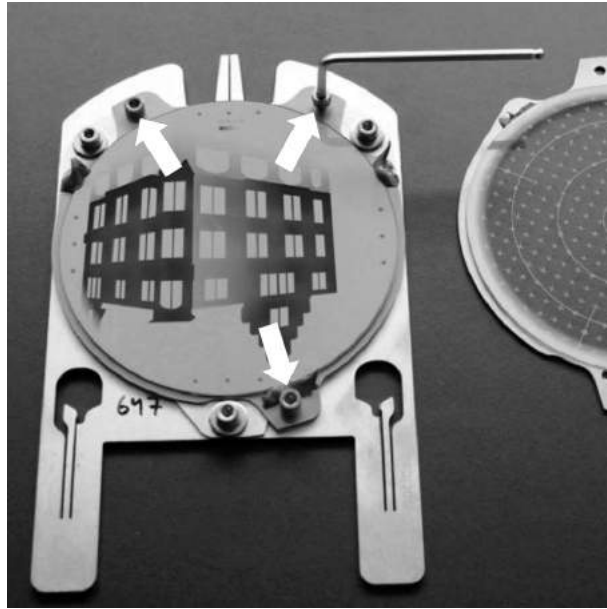

















MUNICIPIO



# progetto esecutivo – dettagli architettonici illuminazione natalizia

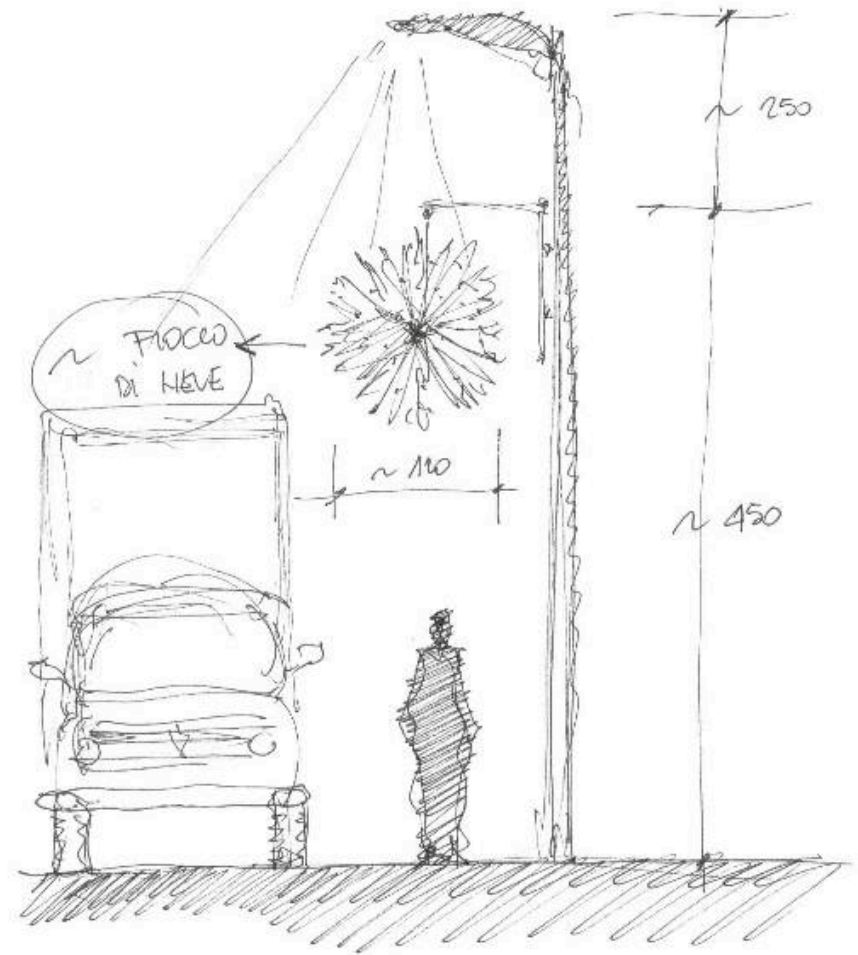
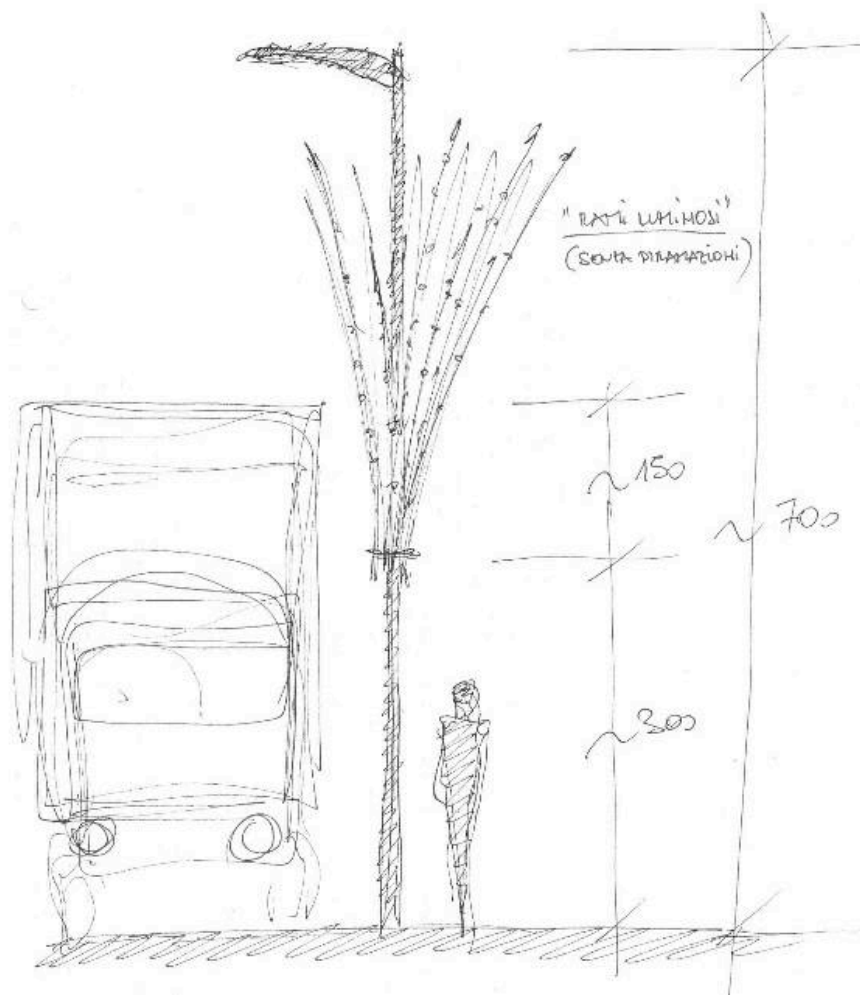













# progetto esecutivo – dettagli architettonici arredo urbano

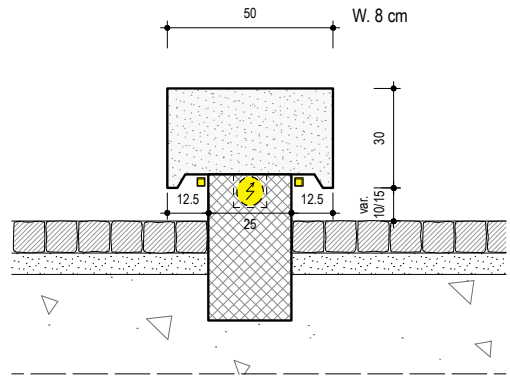
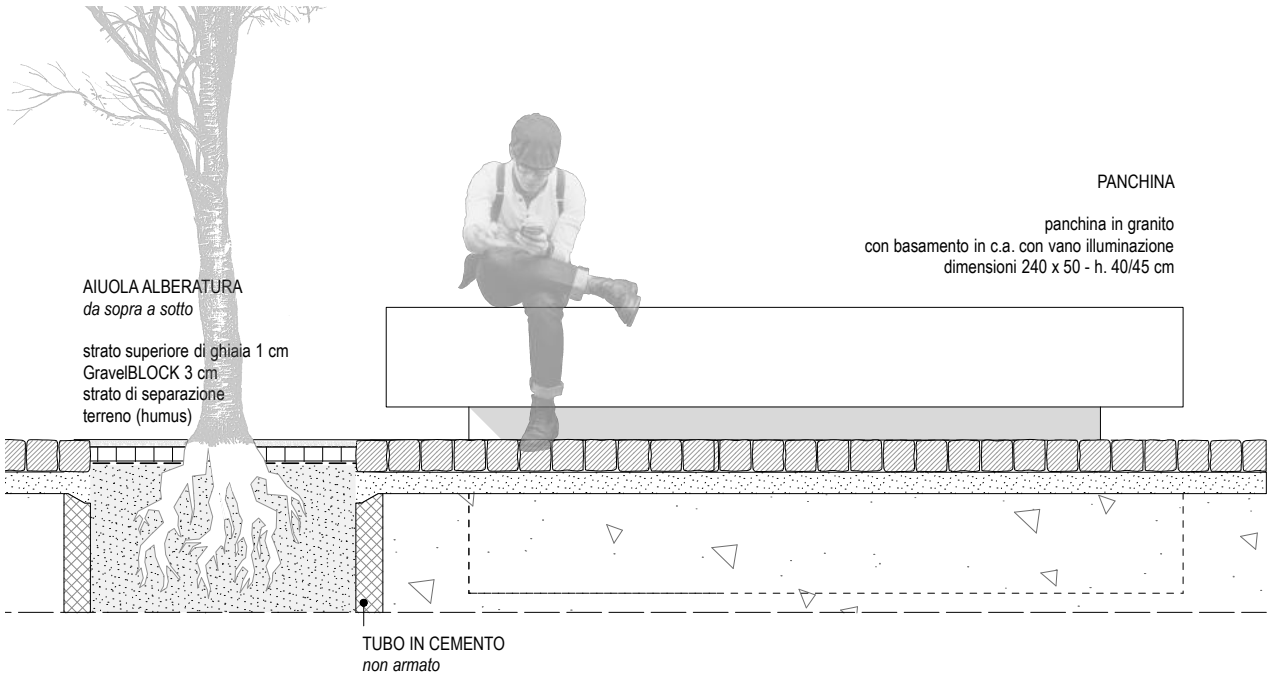
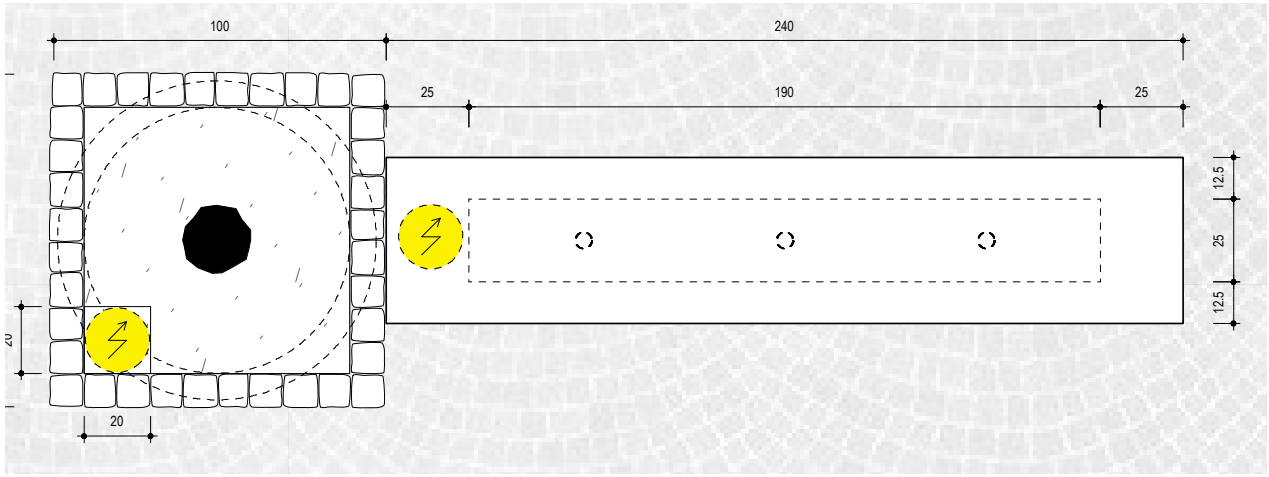



progetto esecutivo – dettagli architettonici arredo urbano



# SALITA DON MUTHER





progetto – collegamento via stazione-via pusterla





# progetto esecutivo – scalinata e corrimano

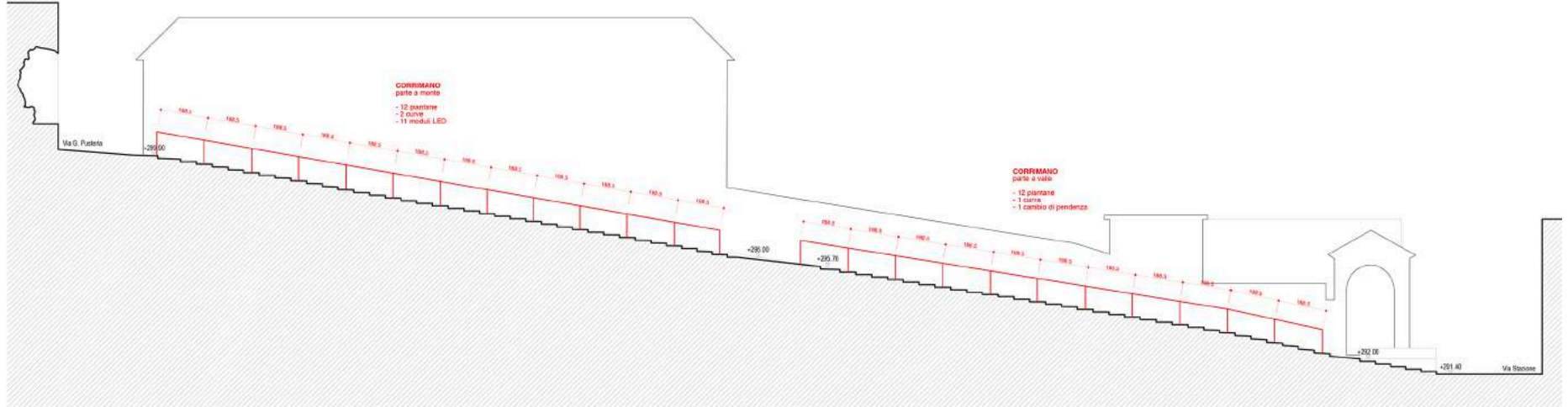

# progetto esecutivo – dettaglio corrimano

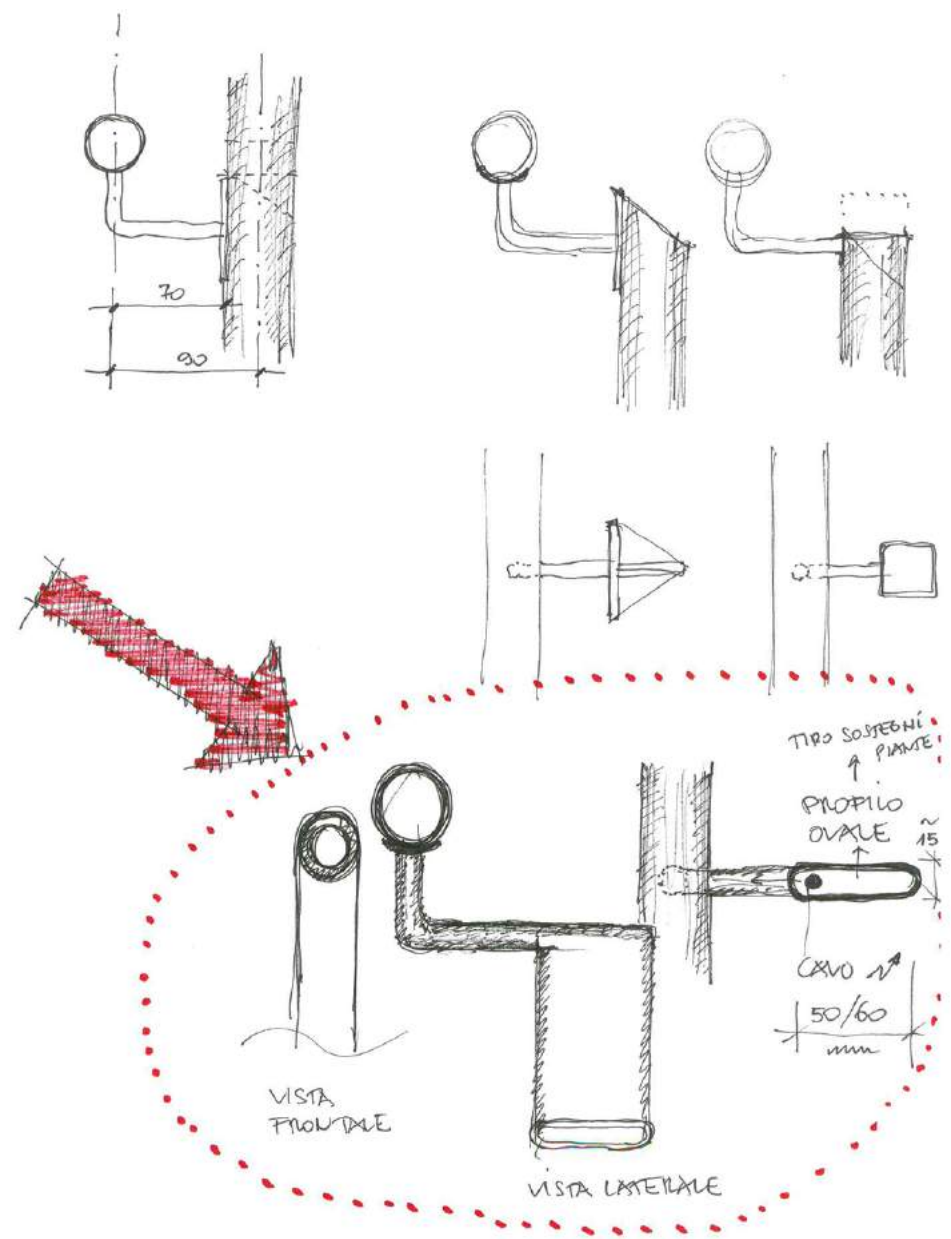
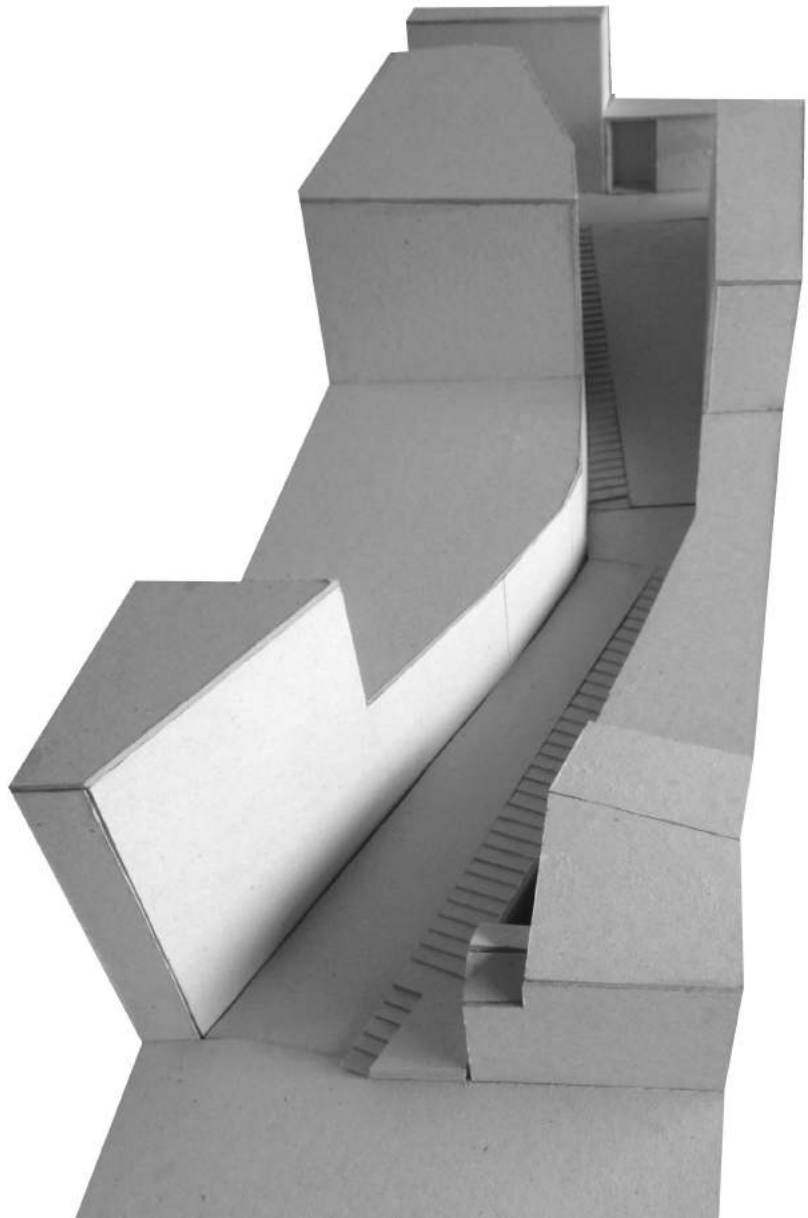

progetto esecutivo – dettaglio corrimano

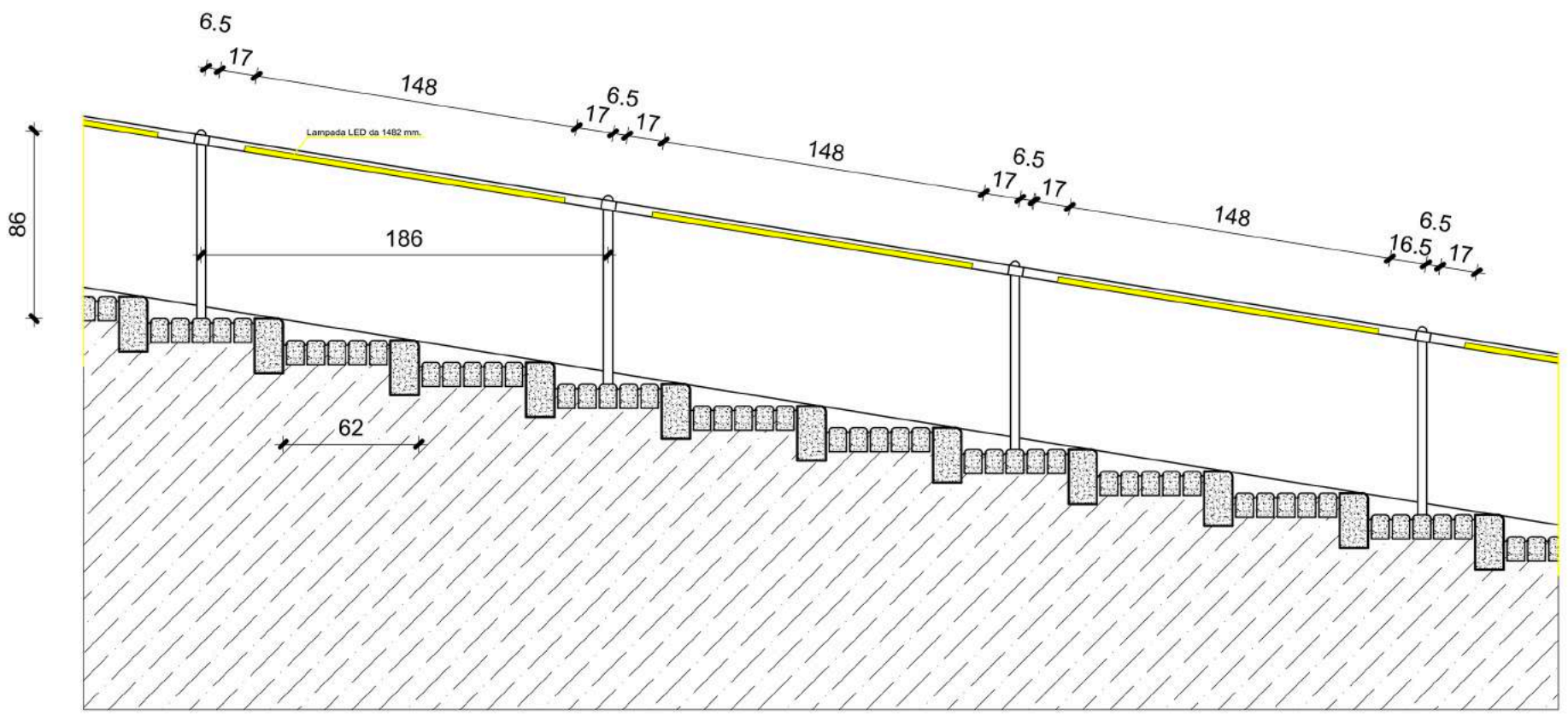



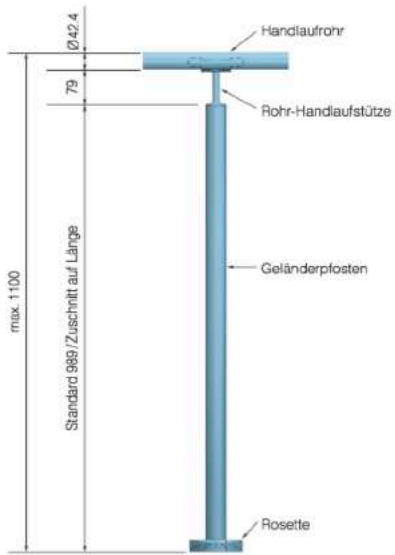
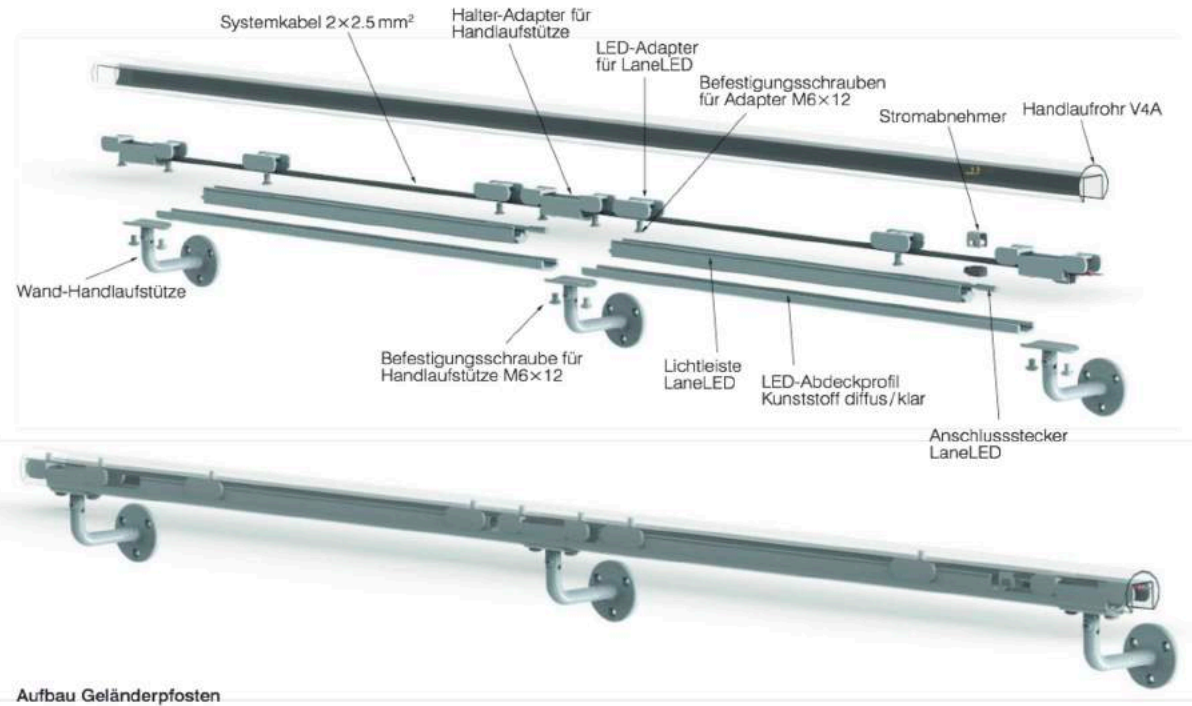

**Handlauf INOX42**

Das Handlauf-Profil von GIFAS, ist das Trägerelement für das INOX42-System. Das Profil und die verschiedenen Befestigungs- und Verbindungsartikel sind so konstruiert und aufeinander abgestimmt, dass die Elektroversorgung mit dem Kabel gewährleistet ist.

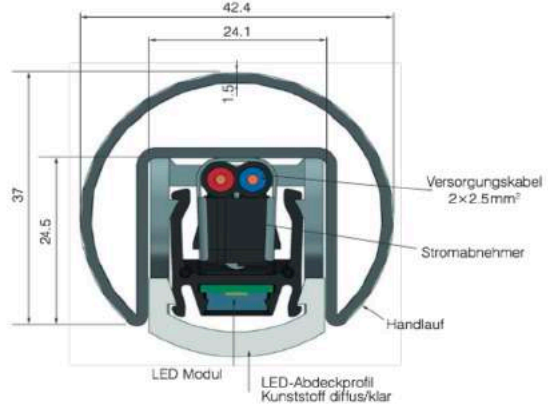

**Ausleuchtung**

Lichtkegel bei der Anwendung für den INOX-Handlauf

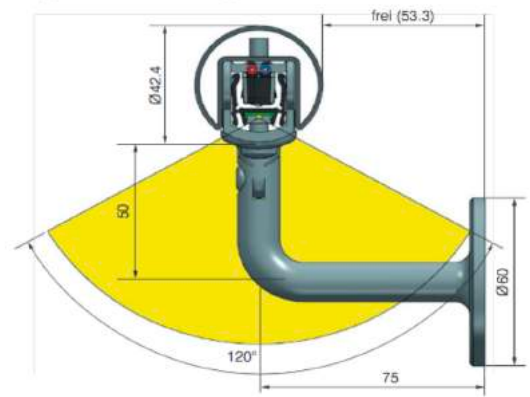



Luminanza nella scena  
 Minimo: : 0 cd/m<sup>2</sup>  
 Massimo: : 33.4 cd/m<sup>2</sup>

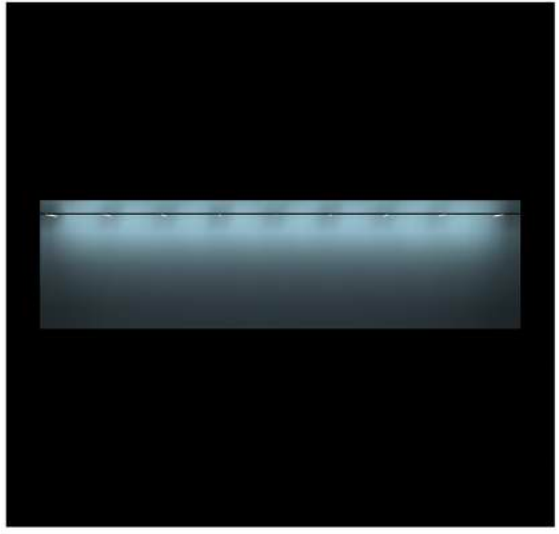

Luminanza nella scena  
 Minimo: : 0 cd/m<sup>2</sup>  
 Massimo: : 33.4 cd/m<sup>2</sup>

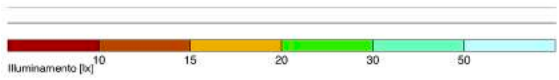
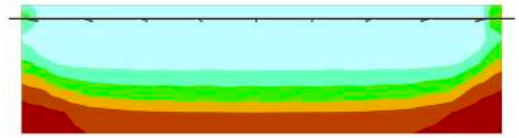
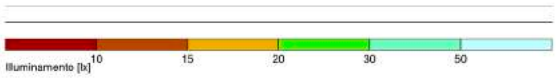
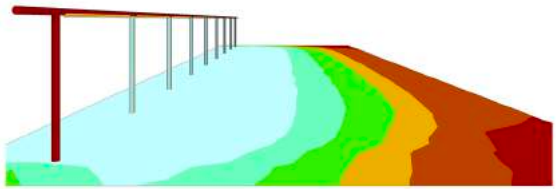

LaneLED INOX42 11 1.481m.Jdt      LaneLED 11 1.481m

**Dati punti luce**  
 Rendimento punto luce : 100%  
 Rendimento punto luce : 60 lm/W  
 Classificazione : A40 - ↓100.0% ↑0.0%  
 CIE Flux Codes : 45 76 94 100 100  
 UGR 4H 8H : 29.6 / 27.1  
 Potenza : 16 W  
 Flusso luminoso : 960 lm

**Dimensioni** : 1481 mm x 20 mm x 20 mm

**Sorgenti:**  
 Quantità : 1  
 Nome : Osram Duris E3

Temp. Di Colore : 4400K  
 Flusso luminoso : 960 lm  
 Resa cromatica : >80

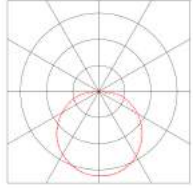





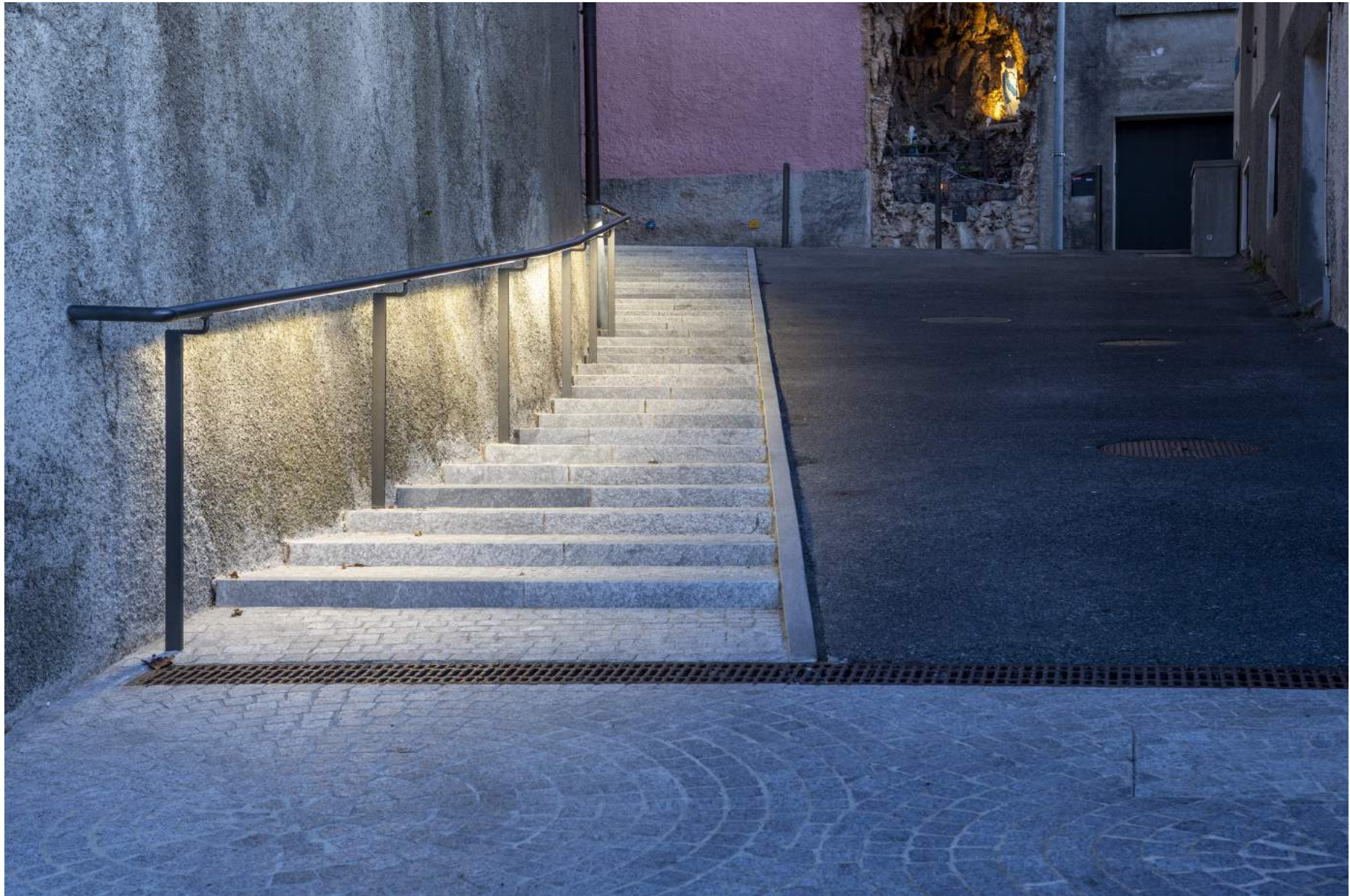







fine  
presentazione